



ASE PTT-LINK

PUSH-TO-TALK (PTT)

ASE-9575PTT-LINK

TRANSFORM AND ENHANCE THE IRIDIUM EXTREME PTT HANDSET

ASE PTT-LINK

Shown below are the components that are included with, or can be used with the ASE-PTT LINK.

COMPONENT DETAILS



Small and Light Weight

Slightly larger than a credit card!



Amplified Audio

Up to 40 hours standard talk. Up to 8 hours under amplify mode.



Optional Holster

Integrates with ASE Modified Holster (Order P/N ASE-HOLSTER).



(Shown with Iridium handset and dongle-not included)

ASE-PTT-LINK

Voltage	6 VDC	Uses Iridium Charger
Power	1 Watts	Active Peak
Connections	S2-PTT	Mini-USB-iridium Dongles
Operating Temp	-10 to 55 C	
Dimensions	6 x 4 x 1 in	15.2 x 10.1 x2 .5 cm
Weight	0.25 lbs	0.6 kg
Shipping Weight	6.0 lbs	2.7 kg
Shipping Dimensions	12 x 12x 3 in	31 x 31 x 7.5 cm

ASE 9575 PTT-LINK EXPANSION ACCESSORY

ADDITIONAL FEATURES/COMPONENTS



Uses the Iridium Charger

- › Uses the 6V Charger for the Iridium Extreme PTT

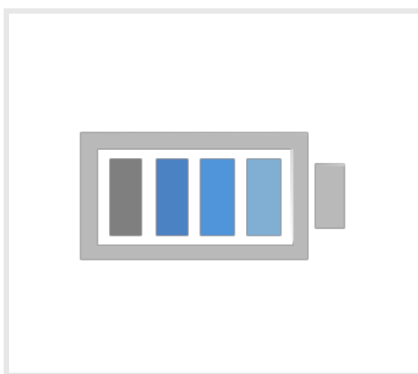

Rechargeable Battery

- › Integrated battery included.
- › 40 hours of operation.
- › 8 hours in amplified mode.

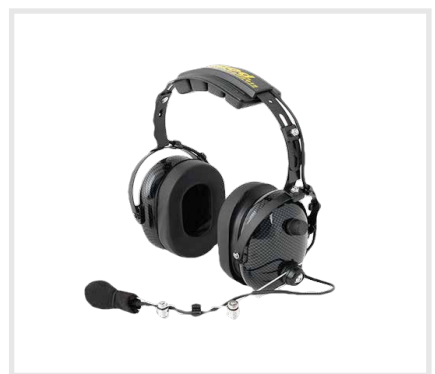

Third Party Accessories

- › Connect other PTT accessories
- › Search ICOM-S2.
- › Contact us for help!

SYSTEM SETUP

PTT Palm Spk/Mic Accessory

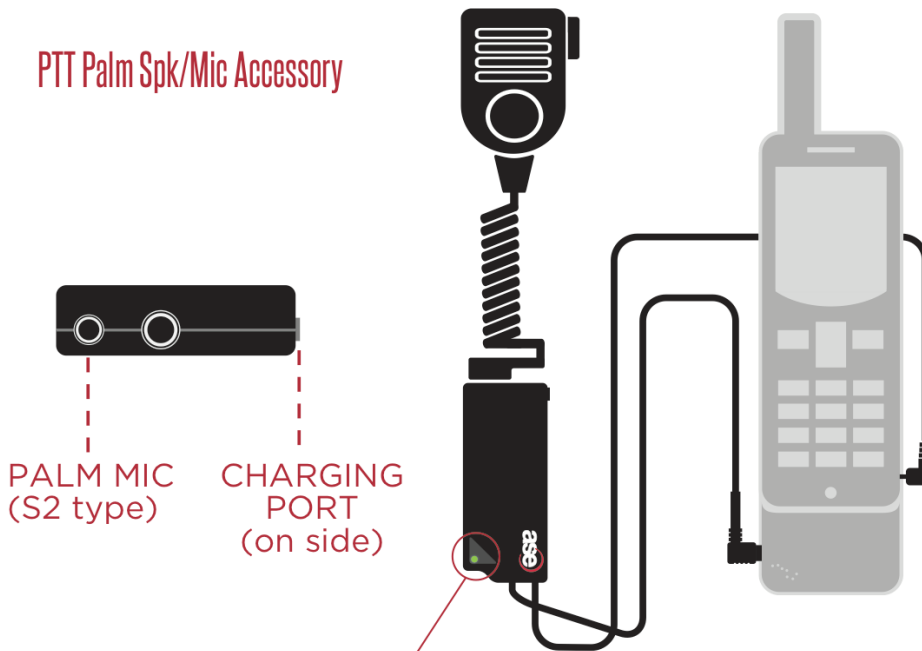



PALM MIC (S2 type)
CHARGING PORT (on side)

BATTERY STATUS INDICATOR

status indicator will activate with every button press

USE IRIDIUM DONGLES
ASE PTT LINK connects using USB Dongles-Charging or Antenna Adapter.

NOTE!
if you use the Antenna Adapter you **MUST** have an External Antenna Connected!

-  = CHARGED
-  = BATTERY LOW
-  CONTINUOUS BLINK = TOO LOW FOR OPERATION

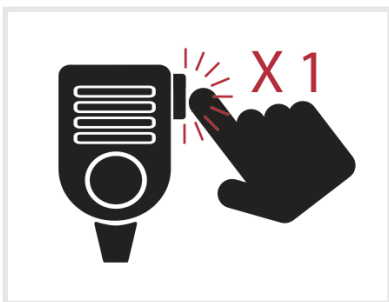

INSTANT ON
Device wakes up on **Single PTT Press**

SUMMARY OF KEY FEATURES:

- › PROVIDES AN ORGANIC LMR (RADIO) EXPERIENCE
- › AMPLIFIES AUDIO-GREAT FOR NOISY ENVIRONMENTS
- › LIGHT WEIGHT
- › INTEGRATED RECHARGABLE BATTERY
- › CONNECT TO VIRTUALLY ANY OTHER PTT ACCESSORY
- › 40 HOURS OPERATION-STANDARD MODE / 8 HOURS AMPLIFIED

PTT PACKAGES AND COMPONENTS

EQUIPMENT AND SHIPPING INFORMATION



ASE-
PTT-LINK

ASE-PTT-LINK: Enhancement and expansion accessory for the Iridium Extreme PTT handset, Recommended for push-to-talk applications. Includes PTT Link module, palm/speaker mic.

Harmonized Code - HTS#: 8518.30.2000 **ECCN:** EAR99

Shipping dimensions: 12in x 12in x 3in, 6lbs (41cm x 36cm x 20cm, 2.7kg)

CONTACT BLUE SKY NETWORK

San Diego, CA Office

5353 Mission Center Road, #222
San Diego, CA 92108, USA

Phone: +1 858-551-3894

E-mail: sales@blueskynetwork.com

Scottsdale, AZ Office

16559 N 92nd Street, #101
Scottsdale, AZ 85260, USA

Phone: +1 480-443-1424

E-mail: sales@blueskynetwork.com



www.blueskynetwork.com

San Diego, CA: +1 858-551-3894

Scottsdale, AZ: +1 480-443-1424

sales@blueskynetwork.com